

STANDARD FRL SERVICE UNIT 2-PART

C520BL / C521BL / C522BL

Description	Service unit, consisting of filter regulator and oiler with pressure gauge, in small design with high flow rate.		
Media	compressed air or non-corrosive gases		
Supply pressure	max. 17 bar		
Adjustment	with lockable adjustment knob for C520BL, with T-handle for C521BL, with adjustment screw for C522BL		
Relieving function	relieving, optionally non-relieving		
Gauge port	G $\frac{1}{8}$ on both sides of the body		
Filter element	40 μ m, optionally 5 μ m, made of sintered bronze		
Bowl	metal bowl with sight glass		
Drainage	manual drain as standard, optionally automatic drain, max. 10 bar		
Temperature range	0 °C to 80 °C		
Material	Body: alu die-cast	Bowl: alu die-cast	Elastomer: NBR
	Spring cage: glass fibre-reinforced plastic		
	Inner valve: brass, plastic		

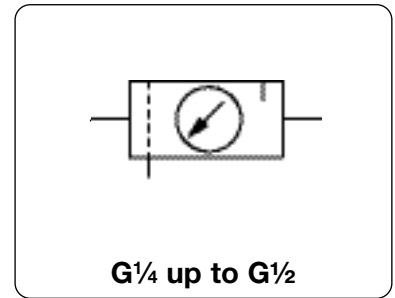

Dimensions			Combination consisting of	Flow rate m ³ /h*1 l/min*1	P ₁ max. bar	Connection thread G	Pressure range bar	Order number
A	B	C						

FRL unit, 2-part				manual drain, relieving, max 17 bar with pressure gauge, Filter element 40 μ m			C520BL		
180	282	165	B520 + L520	132	2100	17	G $\frac{1}{4}$	0.2 ... 2	C520BL-02WJA
			B522 + L520					0.3 ... 3.5	C510BL-02WJB
								1.0 ... 10	C520BL-02WJC
								1.7 ... 17	C522BL-02WJD
180	282	165	B520 + L520	186	3100	17	G $\frac{3}{8}$	0.2 ... 2	C520BL-03WJA
			B522 + L520					0.3 ... 3.5	C520BL-03WJB
								1.0 ... 10	C520BL-03WJC
								1.7 ... 17	C522BL-03WJD
180	282	165	B520 + L520	288	4800	17	G $\frac{1}{2}$	0.2 ... 2	C520BL-04WJA
			B522 + L520					0.3 ... 3.5	C520BL-04WJB
								1.0 ... 10	C520BL-04WJC
								1.7 ... 17	C522BL-04WJD
180	282	165	B520 + L520	408	6800	17	G $\frac{3}{4}$	0.2 ... 2	C520BL-06WJA
								0.3 ... 3.5	C520BL-06WJB
								1.0 ... 10	C520BL-06WJC
								1.7 ... 17	C522BL-06WJD



Special options, add the appropriate letter

T-handle	including locknut	up to 10 bar B + 20 mm	C521BL -0 . W . .
adjusting screw	including locknut	up to 10 bar B + 20 mm	C522BL -0 . W . .
5 μm filter element			C52 . BL -0 . WG .
non relieving	without relieving function		C52 . BL -0 . W . .
automatic drain	SA-500, max. 10 bar		C52 . BL -0 . W . . R

Accessories, enclosed

pressure gauge	50mm, 0... ² bar, G $\frac{1}{8}$	MA5001- . . ²
mounting bracket	made of steel	for G $\frac{3}{4}$ to G1 $\frac{1}{2}$
mounting nut	made of plastic	BW48-00 M48x1,5K

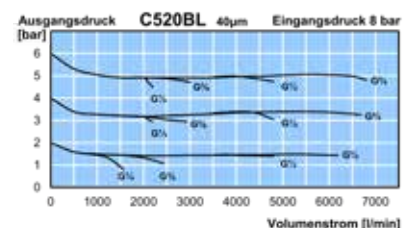
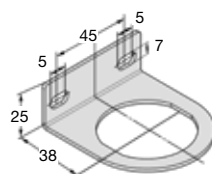
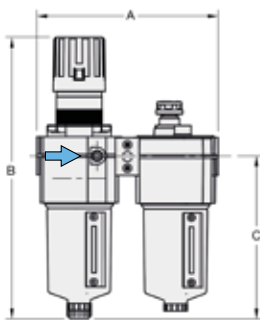

*1 at 8 bar supply pressure, 6 bar outlet pressure and 1 bar pressure drop
*2 02 = 0...2,5 bar, 04 = 0...4 bar, 06 = 0...6 bar, 10 = 0...10 bar, 16 = 0...16 bar, 25 = 0...25 bar

* Product group

Further details: see chapter for single devices
Gauges: see chapter for measuring devices

PDF CAD
www.aircom.net



Order example:
C520BL-02WJA